



# ANLY TIMER

## AH5N WIDE VOLTAGE MULTI-RANGE ANALOGUE TIMER



### CHARACTERISTIC :

- Wide operating voltage range in a single unit, from AC/DC 24V - 240V
- 8 timing ranges from 1sec to 600hour by pushwheel switch
- A/B Mode selectable with a slide switch. A Mode for 2C Delayed output contacts. B Mode for 2C Inst.+Delayed output contacts.
- UL, C-UL recognized and CE certified

### SPECIFICATION :

Operating voltage	AC/DC(V): 24 - 240
Allowable operating voltage range	85~110% of rated operating voltage
Rated frequency	50 / 60 Hz
Contact rating	250VAC 5A (resistive load)
Reset time	MAX 0.2S
Power consumption	Approx. 2VA
Life	Mechanical: 5,000,000 times Electrical: 100,000 times
Ambient temperature	-10 ~ +50°C (without condensation & freezing)
Ambient humidity	MAX 85%RH (without condensation)
Altitude	MAX 2000m
Weight	Approx. 130g

### TYPE SELECTION :

Type	AH5N
Output contact	A / B Mode
Time range	1S / 10S / 1M / 10M / 1H / 10H / 60H / 600H

## CONNECTION :

2C Delayed, A Mode

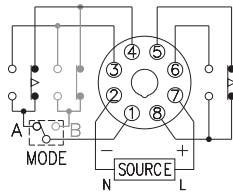

2C Inst.+Delayed, B Mode

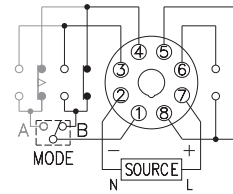

## TIMING CHART :

2C Delayed, A Mode

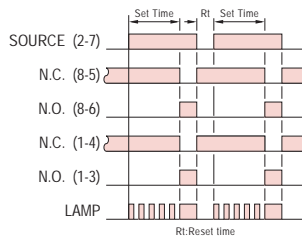

2C Inst.+Delayed, B Mode

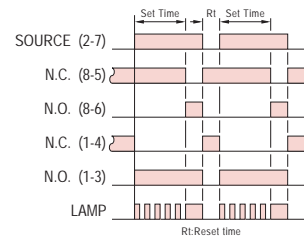

## DIMENSIONS : (mm)

N type(Surface Mounting): Using P2CF-08 Socket or PF085A Socket

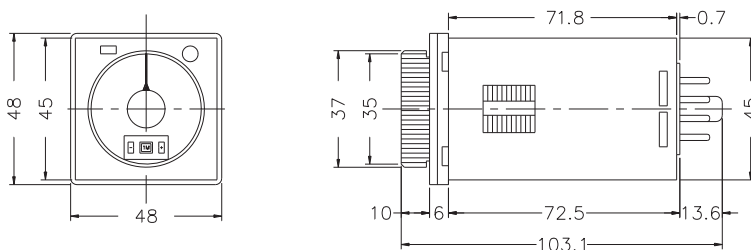

Y type(Flush Mounting): Using Y50 Frame & US-08 Socket or P3G-08 Socket

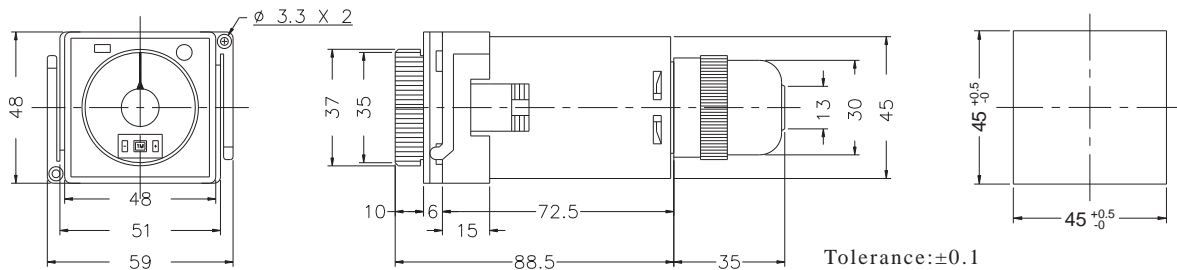

## ANLY ELECTRONICS CO., LTD.

<http://www.anly.com.tw>

### TAIWAN MAIN OFFICE : ANLY ELECTRONICS CO., LTD.

No.19, Lane 202, Fushou St., Xinzhuang Dist., New Taipei City 242, Taiwan  
TEL: +886-2-2996-3202 FAX: +886-2-2996-2017

### HONG KONG OFFICE : ANLY ELECTRONICS (HK) LTD.

Flat K, 13/F, Edward Mansion, 141 Prince Edward Road W., Kowloon, Hong Kong  
TEL: +852-2397-2505 FAX: +852-2397-6080

### CHINA OFFICE : ANLY TECHNOLOGY (WUXI) CO., LTD.

2F, Building A, Plot 1, No. 28, Zhanhong Rd., Xinwu Dist., Wuxi, Jiangsu, P.R.China  
TEL: +86-510-85304801-3

### MALAYSIA OFFICE : JUSTY ELECTRONICS (M) SDN. BHD.

No.1, Jalan 6/89B, Kawasan Perindustrian Trisegi, Batu 3 1/2 Off Jalan Sungei Besi, 57100 Kuala Lumpur, Malaysia  
TEL: +60-3-7983-5758 FAX: +60-3-7981-5052

### INDONESIA OFFICE : PT. ANLY ELECTRONICS INDONESIA

Jl. Pangeran Jayakarta 117/B9, Jakarta Pusat, 10730 Indonesia  
TEL: +62-21-624-8436 FAX: +62-21-626-1228

NO. AH5N-W-A